

# INSTRUCTION MANUAL MODEL OT-03 BBQ

## Introduction

Congratulations on your purchase of the Digital BBQ/Oven Thermometer and Electronic Timer. As most barbecue cooks know the temperature on the cover of a typical grill can vary greatly from the temperature at the grill surface. Also lifting the cover on a grill to check your food allows tremendous heat loss which ultimately changes the cooking time. Now you can view the temperature inside your BBQ/Oven without lifting the cover and you can know the average temperature inside your grill, at the grill surface, during your cooking process. The thermometer will take continual readings every ten seconds and then average them once the temperature has reached 30°F below your set temperature.

## Components

- electronic unit with LCD
- detachable stainless steel probe sensor
- detachable stainless steel clip
- AAA battery

## Features

### LCD (Liquid Crystal Display) -

Displays all icons, temperature and time. See LCD diagram for detailed information.

### Battery Compartment - Holds 1 AAA battery.

**Stand** - Stand unit on tabletop or unclip and re-clip on back of unit to make hanging bracket.

**Magnet** - Stick unit to any metal surface.

## Buttons

1. START/STOP - Starts or stops temperature alert warning and timer.
2. Hr - Sets hour of timer
3. MIN - Set minutes of timer, Press MIN & SEC together resets timer to zero.
4. SEC - Set seconds of timer, Press MIN & SEC together resets timer to zero.
5. "+" "-" - Set alert temperature.
6. °C/°F - Toggle the temperature reading between °C/°F.

## Switch

7. POWER ON/OFF - Turns unit on or off.
8. ALERT ON/OFF - Switches alert mode on or off.

## LCD

1. BBQ/OVEN probe temperature (122°F - 572°F).
2. BBQ/OVEN alert temperature (122°F - 572°F).
3. Above-temp alert icon
4. Below-temp alert icon
5. Optimal icon
6. Timer
7. Alert On icon

## Temperature sensing and timer features:

- Preset BBQ/OVEN alert temperature at 300°F.
- Set your own specific optimal temperature for your BBQ/OVEN.
- Above temperature alert.
- Below temperature alert.
- 20 hours countdown/count up timer.
- Averages BBQ/OVEN temperature and displays it every 10 seconds.

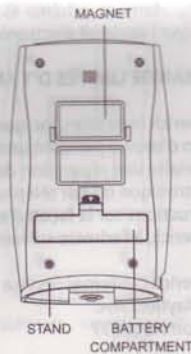
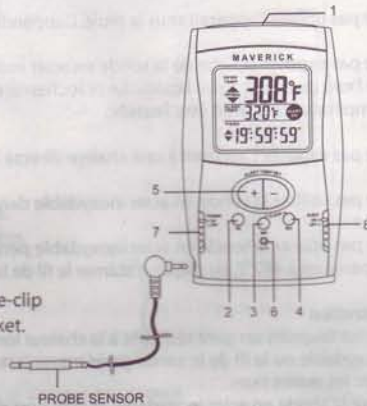

## Set BBQ/OVEN Alert Temperature

Slide Power switch to ON.

Slide Alert switch to OFF position, then press "+" or "-" button to set your own specific temperature. Press and hold the button for fast setting.

Slide Alert switch to ON position the ALERT ON icon will appear on the LCD.

## Temperature Alert

Unit will display actual BBQ/OVEN temperature every 10 seconds if BBQ/OVEN temperature is above 122°F but still 30°F below your BBQ/OVEN alert temperature.

Unit will average and display the BBQ/OVEN temperature when the BBQ/OVEN temperature hits trigger point of 30 F below BBQ/OVEN alert temperature. The ALERT ON icon will flash and the unit will beep 3 times indicating the trigger point has been crossed and the BBQ/OVEN temperature display is now the average BBQ/OVEN temperature averaged and displayed every 10 seconds.

Above temperature alert will beep and flash when the average BBQ/OVEN temperature is 15°F above the set alert temperature for 30 seconds.

Below temperature alert will beep and flash when the average BBQ/OVEN temperature is 15°F below the set alert temperature for 30 seconds or if the average BBQ/OVEN temperature does not reach within 15°F of the alert temperature within 5 minutes of the trigger point.

If the above or below alert beeps and flashes because the average BBQ/OVEN temperature is 15°F out of alert temperature range you can press START/STOP to temporarily stop the beeping. The unit will beep every minute for 5 seconds as long as the average BBQ/OVEN temperature is out of range. You can also slide the Alert switch to Off to suspend all beeping.

If the average BBQ/OVEN temperature is within +/- 15°F of the alert temperature the OPTIMAL icon will be displayed.

## 20 Hour Count Down/Count Up Timer

Count up: Clear the timer value to zero by pressing MIN and SEC keys. Then, press large START/STOP on top of the unit.

Count down: Press HR to set hours, MIN to set minutes or SEC to set seconds. Press START/STOP button to countdown. When time reaches 0:00:00, alert alarm beeps and TIMES'UP icon flashes.

## Example:

If you want to grill a 5 Lb roast beef for 1-1/2 hours you would do the following:

1. Make sure probe is properly mounted to the stainless steel clip and clip it to the wires of the rack inside your BBQ/OVEN. Route the probe wire out of the BBQ/OVEN so it is not pinched. Usually there is a rotisserie hole. Turn BBQ/OVEN to Medium heat.
2. Plug the probe wire jack into the unit and place unit outside the BBQ/OVEN on a nearby surface.
3. Slide POWER switch ON.
4. Press + or - so 350°F is alert temperature displayed.
5. Slide ALERT switch to ON. The ALERT ON icon will be displayed.
6. Press MIN button until 90 minutes is on the timer.
7. "LO" will be displayed for BBQ/OVEN temperature until the temperature goes above 122°F. Above 122°F the actual BBQ/OVEN temperature will be displayed every 10 seconds.

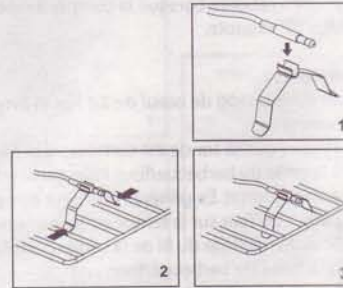

\* Make sure probe is properly mounted to the stainless steel clip and clip it to the wires of the rack inside your BBQ/OVEN.

- When the BBQ/OVEN temperature reaches 320°F (30 degrees below the alert temperature) the trigger point the ALERT ON icon will begin flashing and the unit will beep 3 times.
- The unit is now displaying the average BBQ/OVEN temperature.
- Put the roast beef in the BBQ/OVEN and start the countdown timer by pressing START/STOP button.

If the average BBQ/OVEN temperature does not reach 335°F within 5 minutes of the trigger point the unit will flash and beep the below alert temperature alarm.

If during the cooking the average BBQ/OVEN temperature goes below 335°F or above 365°F for at least 30 seconds the appropriate alert icon will flash and the unit will beep. If the average BBQ/OVEN temperature is below you will need to turn your BBQ/OVEN up and if it is above you will need to turn your BBQ/OVEN down.

Pressing START/STOP button will temporarily stop the beeping. As long as the average BBQ/OVEN temperature is out of range the unit will beep for 5 seconds every minute. The alert icon flashing and beeping will stop once the average BBQ/OVEN temperature is back in range.

- After 90 minutes the TIMER will beep and the TIME'S UP and up arrow icon will flash. Press START/STOP to stop the beeping and timer.

**NOTE:** You can monitor your BBQ/Oven temperature without using the temperature averaging feature just by not switching the ALERT switch ON. In the ALERT OFF mode the unit will display the actual temperature inside your BBQ/OVEN from 122°F - 572°F.

#### HELPFUL HINTS

Reset Timer: Press MIN + SEC to clear timer value to 0:00:00.  
Always clip probe near edge of rack, away from direct heat/flames.

When the temperature of the probe is over 572°F, the unit will display "HI".  
When the temperature of the probe is under 122°F or the probe is not connected to the unit properly, the unit will display "LO". (Picture 2)  
Make sure the probe is properly connected, the unit will show temperature readout when over 122°F.

Do not immerse the probe in the water while cleaning.

#### Cautions:

Always wear a heat resistant glove to touch the stainless steel probe sensor or wire during or just after cooking. Do not touch with bare hands. (Picture 1)

Keep the stainless steel probe sensor and wire away from children.

Clean the stainless steel probe and dry thoroughly after each and every use. (Picture 4)

Do not use the unit in the rain.  
It is not waterproof. (Picture 3)

Do not expose the plug of the stainless steel probe or the plug in hole of the unit to water or any liquid. This will result in a bad connection and faulty readings.

Do not expose the unit to direct heat or surface. (Picture 3)

Do not use stainless steel probe in microwave oven.

Do not use the stainless steel probe sensor above 482°F over 4 hour. Doing so will deteriorate the wire.



(Picture 1)



(Picture 2)



(Picture 3)

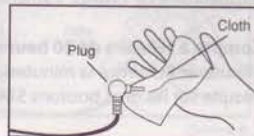

(Picture 4)

#### Cleaning

Always wear a heat resistant glove to touch the stainless steel probe sensor or wire during or just after cooking. Do not touch with bare hands.  
Keep the stainless steel probe sensor and wire away from children.  
Wash the metal probe tip with hot soapy water and dry thoroughly (Picture 4). Do not immerse the probe in water while cleaning.  
Wipe the electronic unit with damp cloth. Do not immerse either in water.

#### LIMITED 1 YEAR WARRANTY

Maverick Industries, Inc. warrants this product to be free of defects in parts, materials and workmanship for a period of one year, from date of purchase. Should any repairs or servicing under this warranty be required, contact Maverick Customer Service by mail or phone for instructions on how to pack and ship this product to Maverick's National Service Center located as follows:

Maverick Customer Service  
94 Mayfield Ave.  
Edison NJ 08837

[www.maverickhousewares.com](http://www.maverickhousewares.com)

Telephone: (732) 417-9666  
Hours: Weekdays 8:30 AM- 4:30 PM

Do not send any parts or product to Maverick without calling and obtaining a Return Authorization Number and instructions.

This warranty is VOID if instructions for use are not followed, for accidental damage, for commercial use, for damage incurred while in transit, or if this product has been tampered with.

This warranty gives you specific legal rights and you may also have other rights which vary from state to state.

Printed in China